

## TFL Generic Truss Light Duty

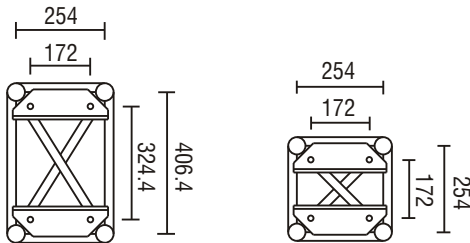

Light Duty Truss is ideally suited to applications where ceiling height or truck space is limited. It is a popular solution for supporting general lighting with spans up to 14 metres. There are two sizes of Light Duty Truss, the standard 305mm high x 305mm wide and a variation measuring 305mm high x 457mm wide.



### Load Table

Span (metres)		3	6	9	12	15
<b>UDL</b>	<b>kg</b>	1809	1248	1048	749	561
<b>DEFL</b>	<b>mm</b>	6	19	43	90	139
<b>CPL</b>	<b>kg</b>	894	593	524	374	281
<b>DEFL</b>	<b>mm</b>	5	16	39	72	116
<b>TPL</b>	<b>kg</b>	557	426	393	281	211
<b>DEFL</b>	<b>mm</b>	5	18	49	89	141
<b>QPL</b>	<b>kg</b>	437	302	262	187	140
<b>DEFL</b>	<b>mm</b>	5	18	46	84	133

Span (metres)		3
<b>Cantilever Span</b>		3
<b>UDL</b>	<b>kg</b>	468
<b>DEFL</b>	<b>mm</b>	11
<b>CPL</b>	<b>kg</b>	281
<b>DEFL</b>	<b>mm</b>	16

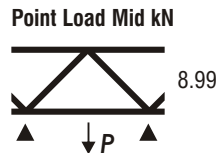

Connection: Gusset Plate. Fixings: M16 x 45 HT Bolt, Nut & Washers

- All loads are given in Kilograms
- Allowance has been made for self-weight of truss
- Allowance has been made for frequent use factor of 85% according to prEN17115
- The payload of the truss has been calculated as a permanent action. Should it be necessary to consider the payload as a variable action, the tabulated figures should be reduced to 90% of the given values

## TFL Generic Truss Light Duty



### Material Specifications

Main Chord:	50.8mm x 3.25mm
Braces:	25.44mm x 3.25mm
Material Specifications:	EN AW-6082 T6
Fixings:	M16 x 45mm grade 8.8 HT Nuts & bolts

### Accessories

Circles
Angled Corners
Bespoke Lengths
Hinges and Swivels

### Item Codes, Weights and Dimensions

LD5FN	LD 5ft Truss Section	1524mm x 305mm x 305mm	17kg
LD8FN	LD 8ft Truss Section	2438mm x 305mm x 305mm	22kg
LD10FN	LD 10ft Truss Section	3048mm x 305mm x 305mm	27kg
LD1MN	LD 1M Truss Section	1000mm x 305mm x 305mm	11kg
LD2MN	LD 2M Truss Section	2000mm x 305mm x 305mm	19kg
LD3MN	LD 3M Truss Section	3000mm x 305mm x 305mm	27kg
LD4MN	LD 4M Truss Section	4000mm x 305mm x 305mm	35kg
LDC4MN	LD 4 Way Corner Section	305mm x 325mm x 325mm	20kg

### Design Specification

Manufactured in accordance with

BS EN 1090-3:2008 : Technical Requirements for aluminium structures

EN ISO 9001:2008 : Quality management systems

BS EN 1999 Pt 1-1 : Design of Aluminium Structures, General structural rules

pREN 17115 : Entertainment Technology – Specification for design and manufacture of aluminium and steel trusses.

